

N.K.I.L. 1294 R.P., 1600 R.P., 1599 R.P., 1598 R.P., 1417 R.P., 1597 R.P., 1397 S.A R.P., 1397 R.P. & 1596 R.P.

Kam Wah Mansion, Nos. 226-242 Cheung Sha Wan Road, Cheung Sha Wan, Kowloon

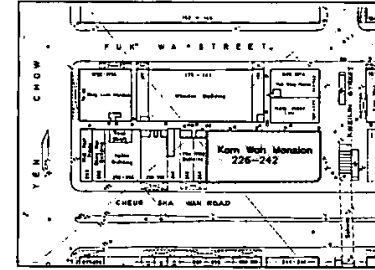

FIRST FLOOR PLAN (SCALE 1: 200)

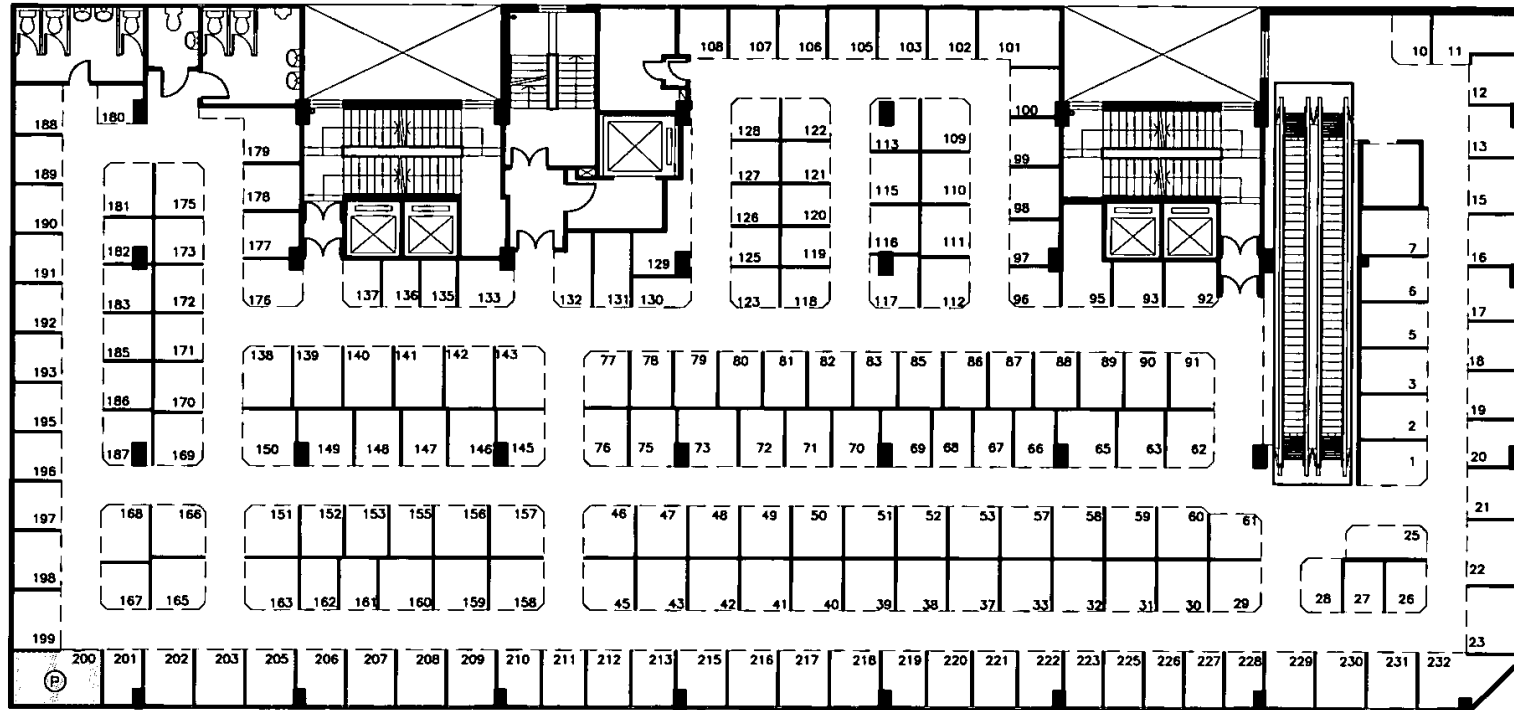

註冊摘要編號 MN: 05042102100035 A4C

A handwritten signature in black ink, appearing to read 'Chan Chun Wai, Samson'. The signature is written in a cursive, flowing style.

Chan Chun Wai, Samson
- Authorized Person (Surveyor)